

Thunder Series Fiber Laser

CWX-60000



FEATURES:

- ◆ Good beam quality
- ◆ Good power stability
- ◆ Good system reliability
- ◆ Easy-to-use control

APPLICATION:

- ◆ Laser cutting
- ◆ Laser welding
- ◆ Additive manufacturing
- ◆ Sheet metal processing

BWT Thunder series fiber lasers have good beam quality, which makes them perfect choices for precision processing. The two operation modes, CW and modulation, minimize heat-affected zone. Reliable performance, modular and all-fiber design, and robust case enclosing all optical and electronic components ensure that they can be used under strict industrial conditions.

BTW Thunder series fiber lasers can be used in wide application like precision processing, drilling, sheet metal processing, additive manufacturing, etc. The lasers can process various types of metal, including aluminum-based and nickel-based alloys, titanium alloys and alumina ceramics.

BTW professional laser application team, with good knowledge and experience, provides the best laser system solution for our customers all around the world.

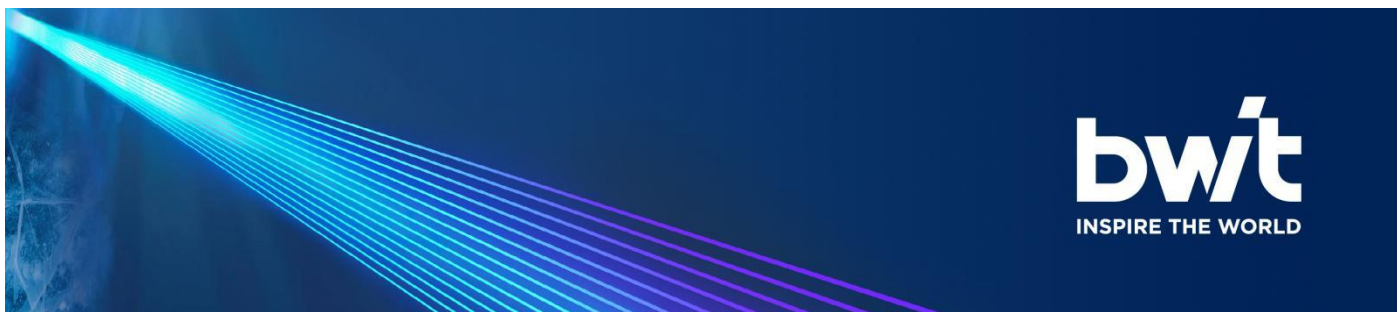

Thunder Series Fiber Laser

CWX-60000

Optical Character	
Power	60000 W
Wavelength	1080±10 nm
Output Fiber Core Diameter	150 μm
Output Cable Length	30 m or customized
Output Cable Connector	QF or QF-D
Aiming Beam	Red
Operation Mode	CW or modulation
Polarization	Random
Power Stability (25°C)	< ±1.5% (2h)
Power Adjustment Scope	10%-100%
Max Modulation Frequency	5kHz
Size and Weight	
Physical Size (H×W×D)	1235mm*1175mm*1510mm
Weight	~ 850 kg
Electronic Character	
Power Supply	380±20 V, AC, PE, 50/60 Hz
Power Consumption	200 kW
Control Interface	RS232/AD
Water Cooling Parameters	
Minimum Water Cooling Capacity	≥ 120 kW
Temperature Settings	22°C (Laser Module), 30°C (QF/QF-D)
Cooling Tubes Size	I.D. Φ50 mm, ×2
Cooling Water Flow Rate (Laser)	600 L/min
Cooling Water Flow Rate (QF/QF-D)	3.0 L/min
Cooling Water Flow Rate (Cable)	1.5 L/min

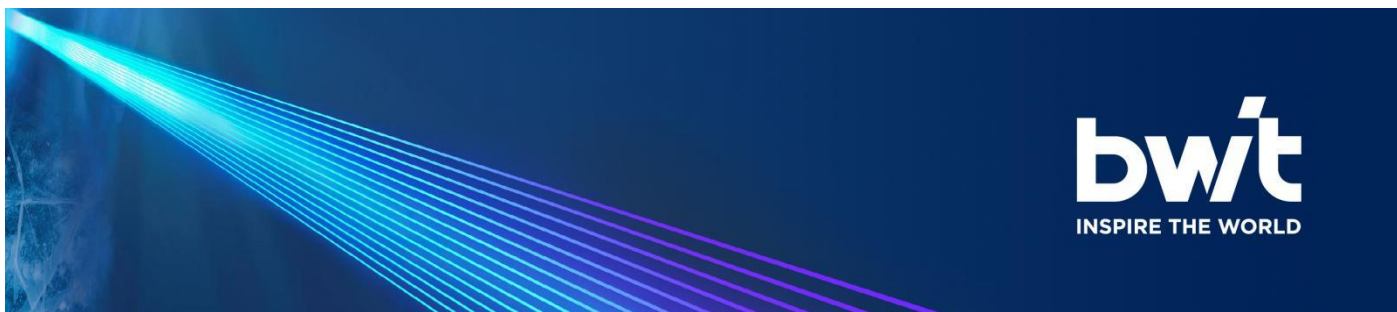

Thunder Series Fiber Laser

CWX-60000

DEMINSIONS (mm)

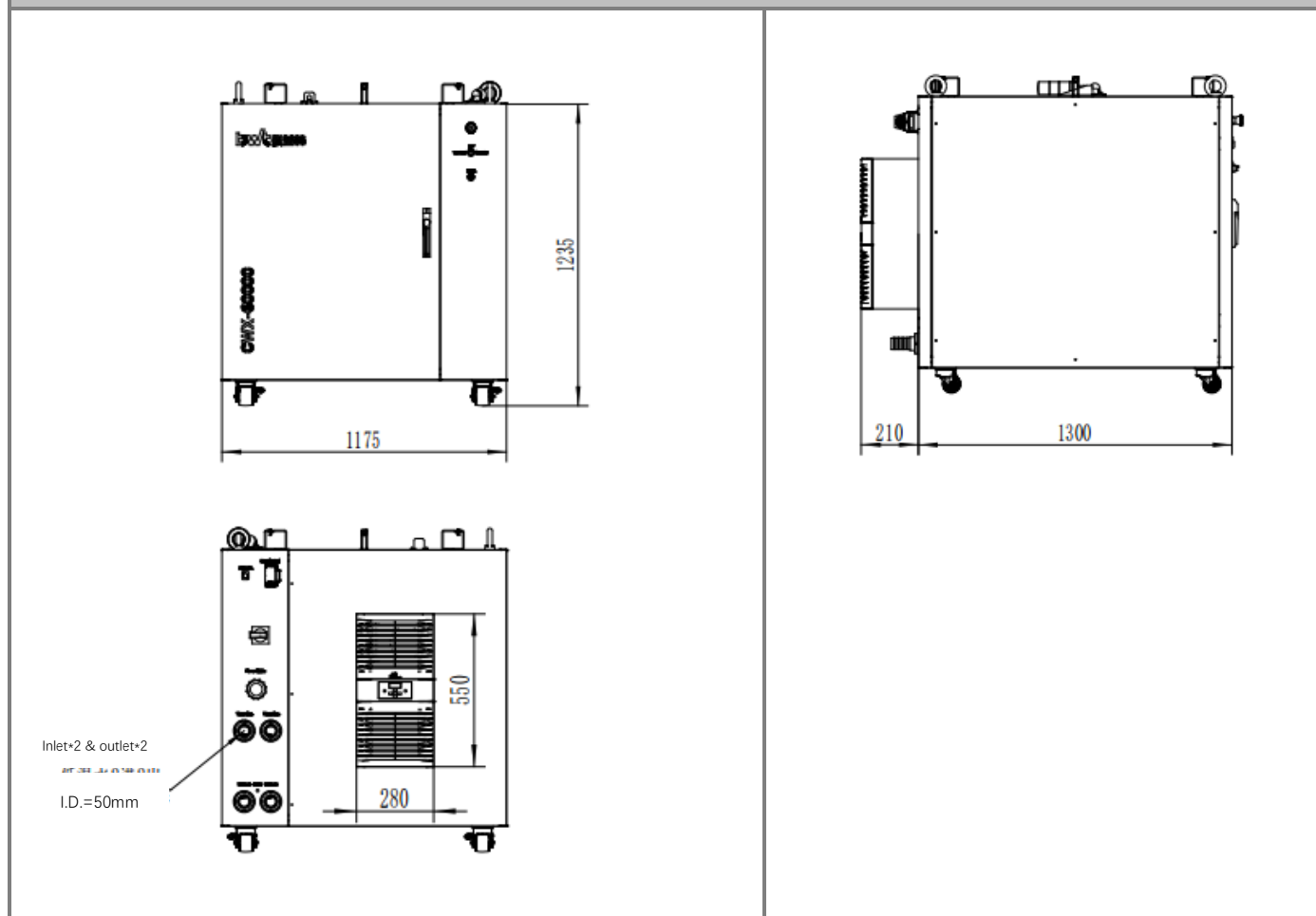

Declaration: information and specifications contained herein are deemed to be reliable and accurate. BWT Tianjin Ltd. reserves the right to change, alter or modify the design and specifications of these products at any time without notice.